

# CXT Series

ø12, ø16, ø20,  
ø25, ø32, ø40



## Construction

CXTM  
Guide rod/Bearing

CXTL  
Guide rod/Bearing

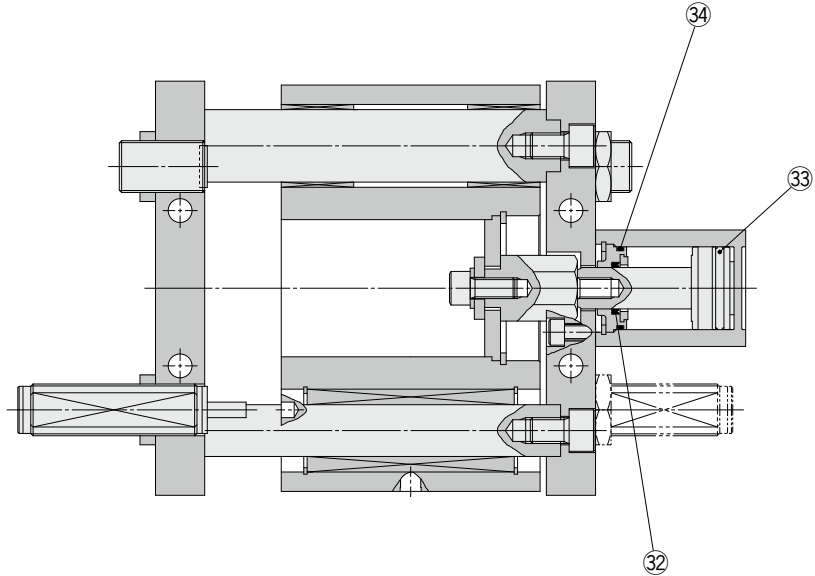

\* The numbers correspond with those in the "Construction" of the CXT series in the **Web Catalog**.

### Seal Kit List

No.	Description	Material	Note
32	Rod seal	NBR	
33	Piston seal		
34	Tube gasket		

### Replacement Parts: Seal Kit

Model	Cylinder	Part no
<b>Standard stroke</b>		
CXT□12	CDQSB12	CQSB12-PS
CXT□16	CDQSB16	CQSB16-PS
CXT□20	CDQSB20	CQSB20-PS
CXT□25	CDQSB25	CQSB25-PS
CXT□32	CDQ2A32	CQ2B32-PS
CXT□40	CDQ2A40	CQ2B40-PS
<b>Long stroke</b>		
CXT□12	CDQSB12	CQSB12-L-PS
CXT□16	CDQSB16	CQSB16-L-PS
CXT□20	CDQSB20	CQSB20-L-PS
CXT□25	CDQSB25	CQSB25-L-PS
CXT□32	CDQ2A32	CQ2A32-L-PS
CXT□40	CDQ2A40	CQ2A40-L-PS

\* The seal kit includes 32, 33 and 34. Order the seal kit with the kit number.

\* Since the seal kit does not include a grease pack, it should be ordered separately.

**Grease pack part no.: GR-S-010 (10 g)**